

A close-up photograph of a person wearing a white lab coat and white gloves, working with a laboratory instrument. The person is holding a small vial with a blue cap, which is being placed into a circular tray containing several other vials. The instrument is white and has a circular opening where the vials are being handled. The background is slightly blurred, showing more of the laboratory environment. The text "PLCnext活用了した 外観検査システム" is overlaid on the image in a bold, black font.

**PLCnext活用了した
外観検査システム**

三機 様 AI外観検査装置のPLCnext デモ機 構成案

⑤ IO接続

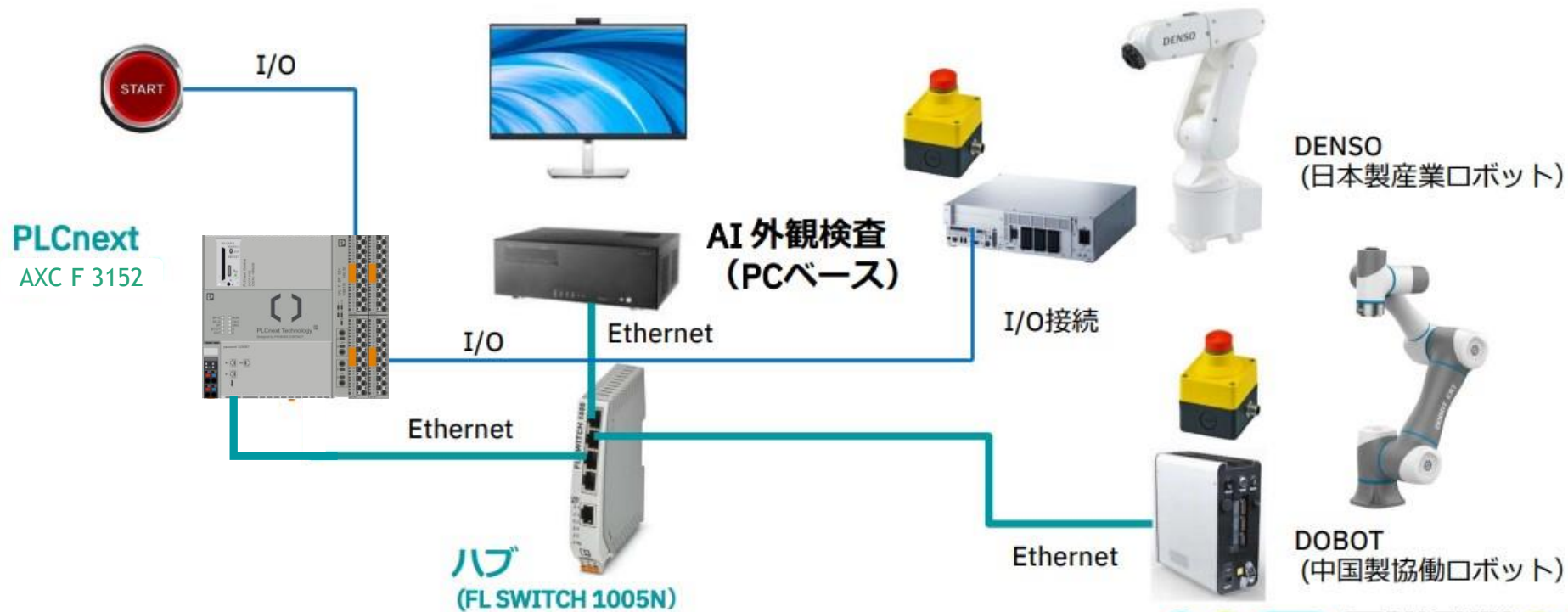

設備 外観図

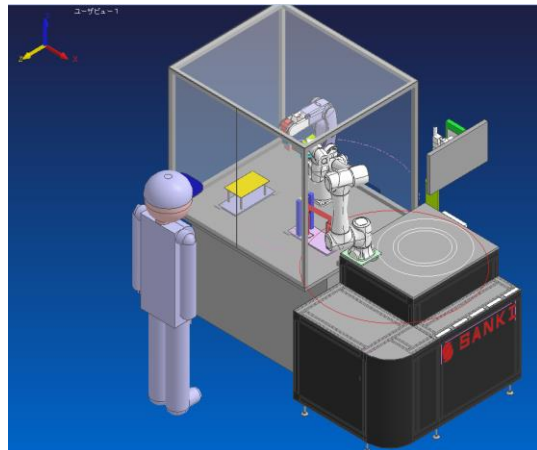

それぞれ別設備(別メーカーのロボット)
を組み合わせて外観検査と搬送を自動化

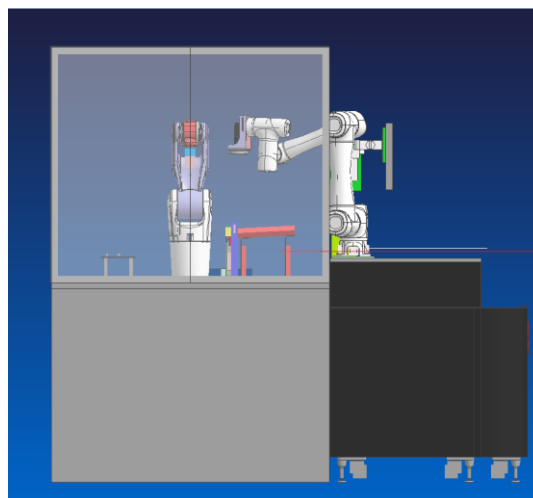

設備 正面

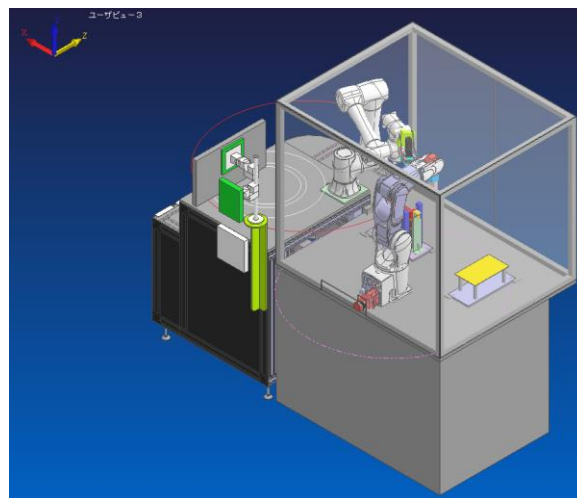

設備 背面

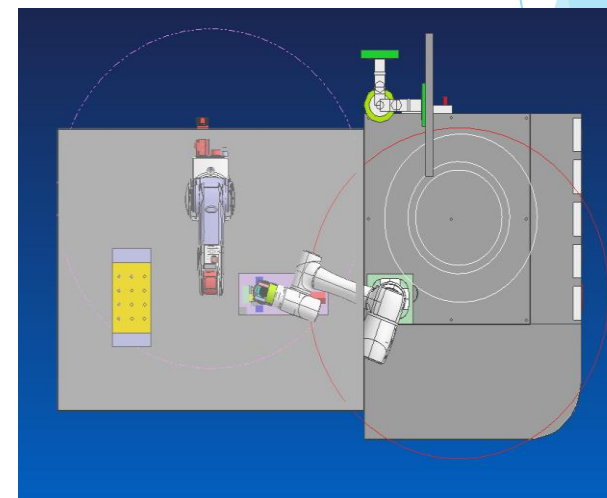

設備 平面

設備範囲説明

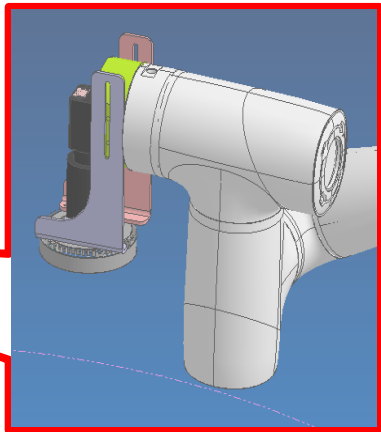
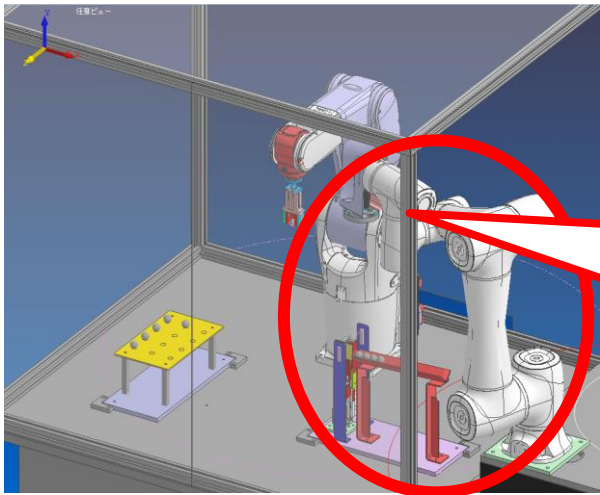

視覚ユニット

視覚検査R/B
(アームの先端にカメラを取付、鉄球の外観を見る)

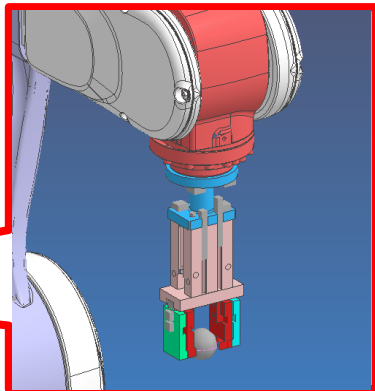
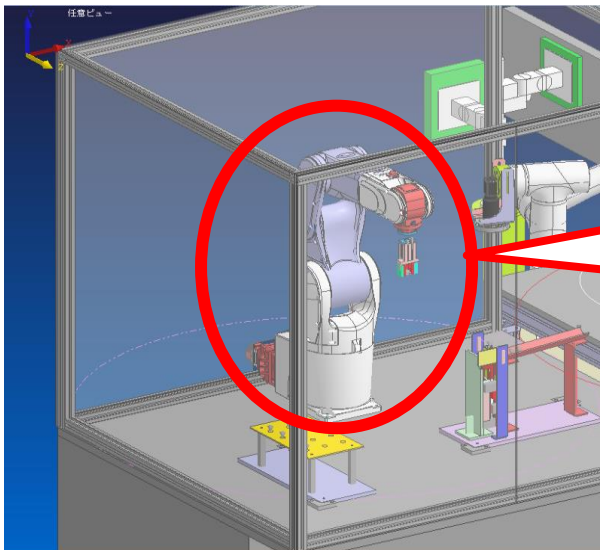

チャックユニット

ワークチャックR/B
(先端部のチャックユニットにてワークを掴み、指定の位置に置く。)